

## SBS Details: D1.7.4-1 Counter-flashings & Reglets (Deck – Wall Supported)

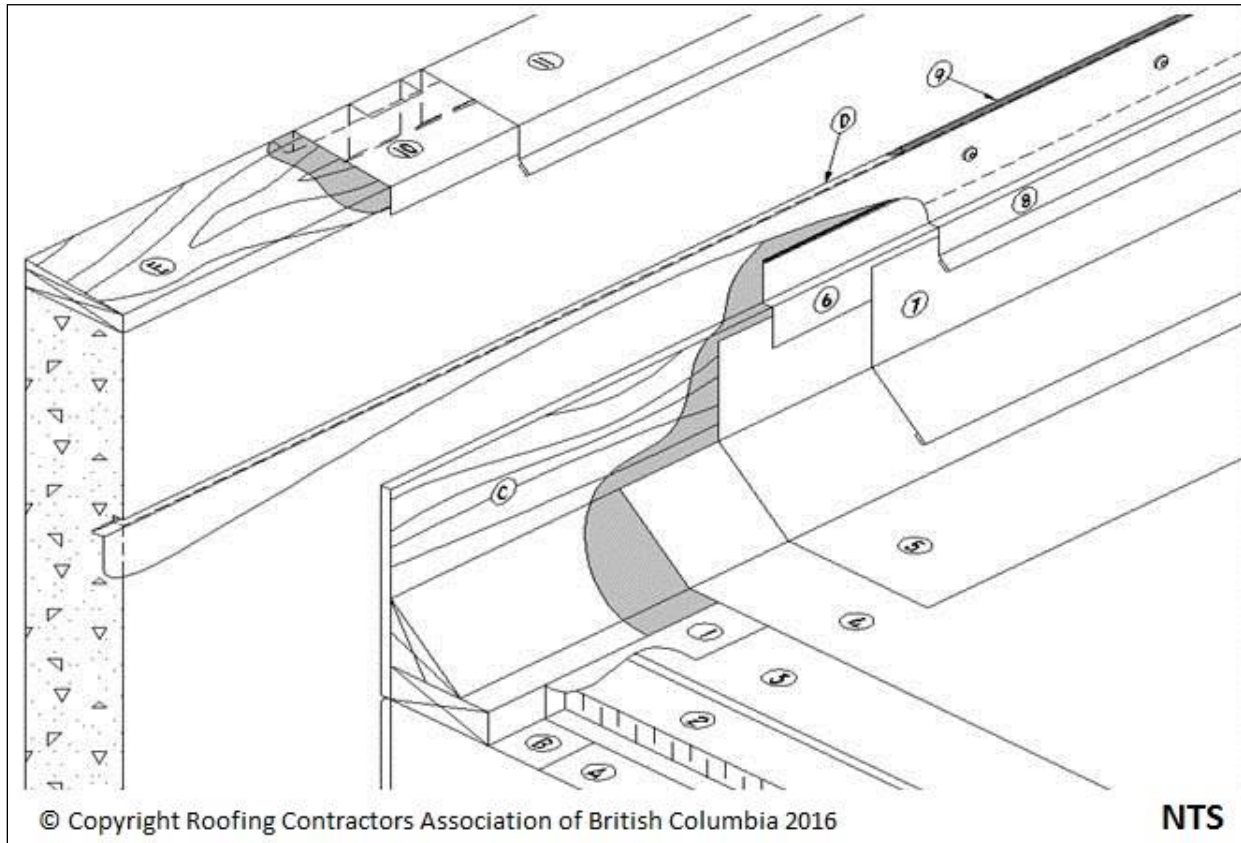

**Notice to reader:** Drawing for illustration purposes only. Consult the RoofStar Guarantee Standards for more information.

### 1 WORK INCLUDED

(1) [Vapour Retarder](#)

The requirement for a vapour retarder is determined by the design authority.

(2) [Insulation](#)

See available insulation products in the [Accepted Materials](#) section of this Manual.

(3) [Insulation Overlay](#)

Where required.

(4) [Primary Membrane and Membrane Protection](#)

(5) [Membrane Flashing](#)

Mechanically fasten to inside of plywood.

(6) [Membrane Counter-flashing](#)

Flashing sealed to wall with compatible mastic.

(7) [Metal Base Flashing](#)

Optional on flexible membrane systems. Required on assemblies using gravel ballast filter mats.

(8) [Metal Counter-flashing](#)

Into reglet approximately 30 mm (1 ¼") and caulked.

(9) **Caulking**

(10) [Membrane Underlay](#)

Minimum self-adhered modified bitumen membrane.

(11) [Metal Cap Flashing](#)

Fasten with continuous concealed clip-type fasteners or cladding screws evenly spaced between seams.

---

## 2 RELATED WORK BY OTHERS

(A) [Acceptable Deck](#)

(B) [Air/Vapour Seal](#)

Sealed to wall.

(C) [Plywood](#)

(D) [Reglet](#)

Purpose-made, installed prior to concrete placement or saw-cut.

(E) [Sloped Wood Blocking](#)

Required over 100 mm (4") parapet width.